

How To Check The Oil In Your Generator

KOHLER 14KW TO 20KW

If your Kohler home generator has been operating during an extended power outage, here are a few tips from our service team to keep handy. Please note that these are merely suggestions and maintenance guidelines. Please refer to your owner's manuals for exact specifications and maintenance schedules. It's very important to service your generator correctly and in a timely manner.

Q: How do I open the unit?

A: When you purchased your generator, you get a literature packet that contains the key. Insert the key into the lock and turn it 45° to unlock. Lift the hood.

Q: How do I turn off my generator?

A: Open the hood. Move the circuit breaker to the OFF position to stop powering the house. The circuit breaker is located below the black controller. Once switched OFF, let the generator run for 2-5 minutes then press the blue OFF button located on the controller.

Q: How long can it run before I need to check the oil?

A: Be sure to check the oil every 8 hours and change the oil after every 100 hours of use. If this is not possible, at the very least, check the oil every 24 hours. It's very important that the oil is checked and changed correctly in a timely manner to avoid damaging your generator. It's important not to rely on the low oil pressure switch (which is very different from a low oil level switch) to shut the machine down. The damage will most likely already be done by the time this occurs.

Q: How much oil will my generator consume?

A: Since variables such as engine hours, load, model, and other factors influence fuel consumption, there is no standard amount of oil being consumed. As long as you check the oil level and change the oil as instructed then your generator should be in good condition.

Q: What type of oil do I put in the generator?

A: We recommend 5W30 Full Synthetic Oil.

Q: Where is the dipstick?

A: The dipstick is located on the back of the engine and has a yellow ring or handle on the end of it.

Q: What do I do when the water rises above the generator?

A: If it's safe to go outside, turn your generator OFF. If you can't get to your generator and it continues to run while submerged in water, there will most likely be internal damage. There is not much else you can do. Remember, water and electricity can be very dangerous and if the generator is submerged, you will have both conditions.

Q: How do I check the oil?

A: After you turn off the generator, allow the engine to sit for 2 minutes to let the oil settle. To check the oil level, pull the dipstick from the back of the engine, wipe it with a clean rag and place it back into the dipstick tube. Pull the dipstick back out and examine the end of the dipstick. The end of the dipstick has crosshatching between an 'F' (full) and an 'L' (low). The oil level should fall between these two markings. If it is towards the low end, add oil.

To add oil, find the yellow cap (that's engraved with a picture of an oil can) or it could be a black rubber fill port as shown in the below pictures depending on the model Kohler generator that you have. Add a few ounces of oil then check the oil level again by inserting and removing the dipstick.

Repeat these steps and continue adding oil until the level is at or near the 'F'. Do not overfill the engine. Once oil is at a desirable level, start the generator by pressing the AUTO button. After the generator is started, flip the circuit breaker to the ON position and the generator should be supplying power to the house.

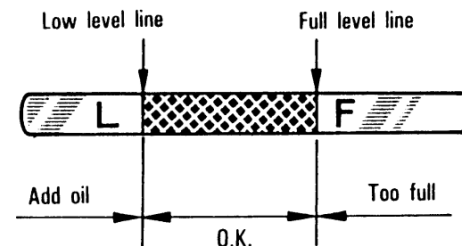
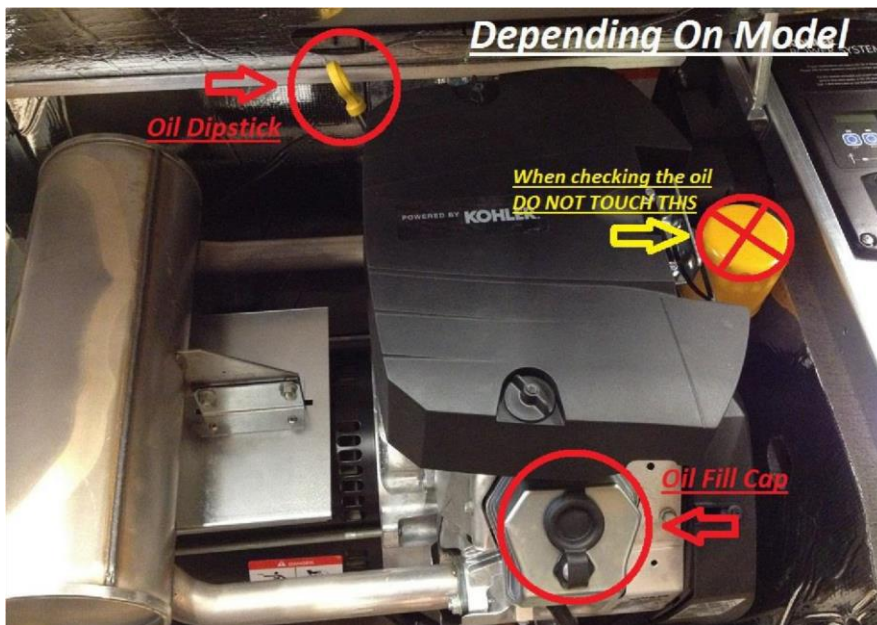
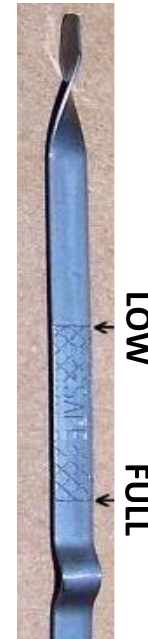
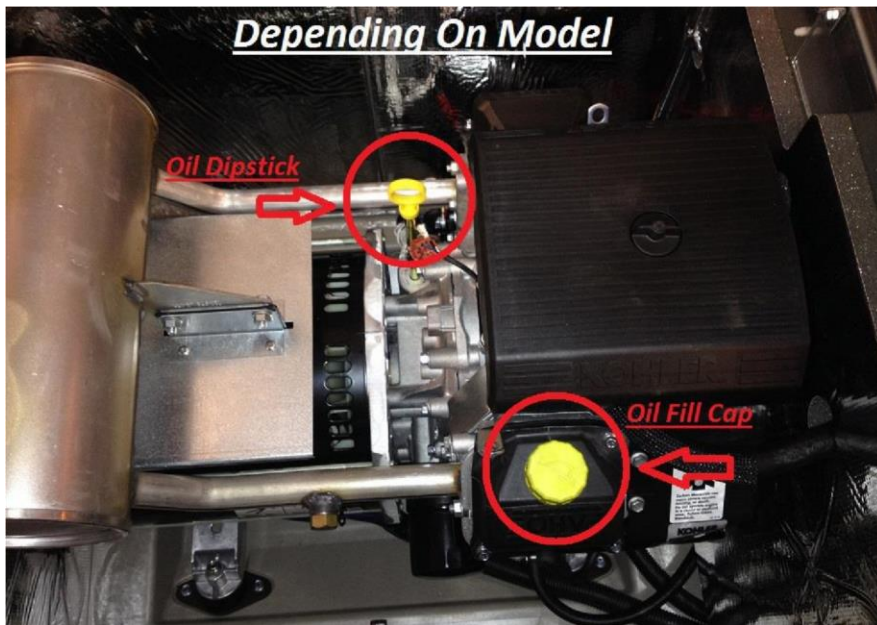

***Please don't hesitate to call the office with any questions
781-294-8300***