

4 HOLE "D" BOX WITH ALL HOLES LEVEL

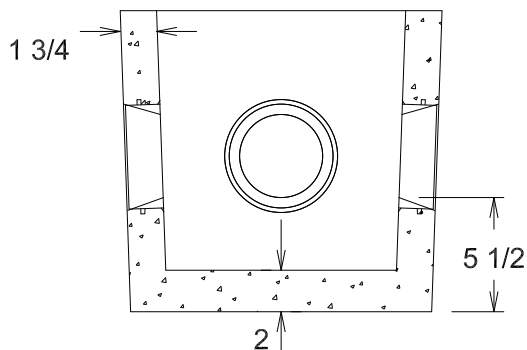
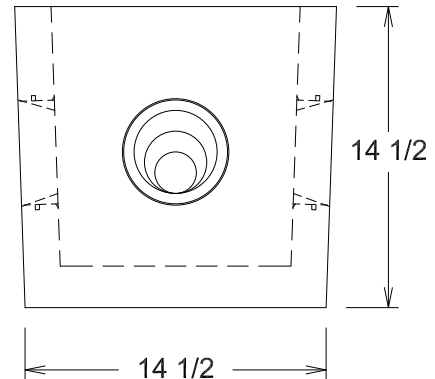
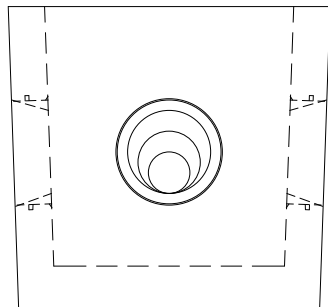
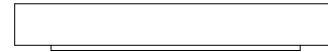
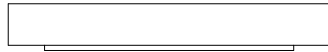
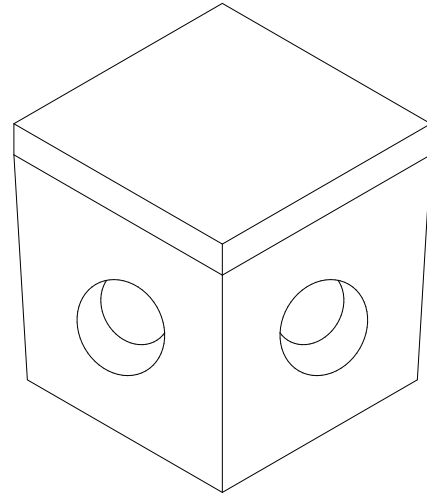
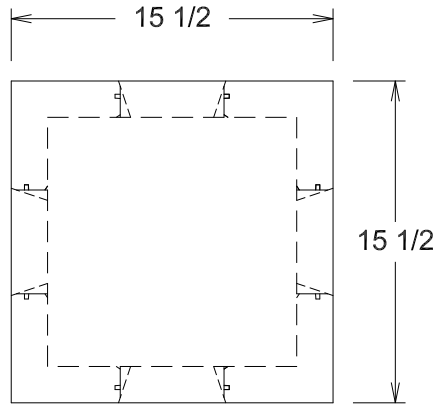

DESIGN NOTES

- 1) ALL HOLES ARE AT SAME HEIGHT
- 2) INLETS AND OUTLETS HAVE STATE APPROVED SEALS THAT ACCEPT 4" S-40, 4" SDR-35, 3" AND 2" PIPE
- 3) TYPE II CEMENT ASTM C150-81
- 4) CONCRETE STRENGTH 5000 PSI. MIN. 28 DAYS